

**2022 WISCONSIN STATE HUNTING AND FISHING EXPO
RESCH EXPO CENTER - GREEN BAY, WI
FEBRUARY 25-27, 2022**

← 1.6 MILES TO I-41

LOMBARDI AVE

LOMBARDI AVE

S ONEIDA ST

LAMBEAU FIELD PARKING

LAMBEAU FIELD PARKING

S ONEIDA ST

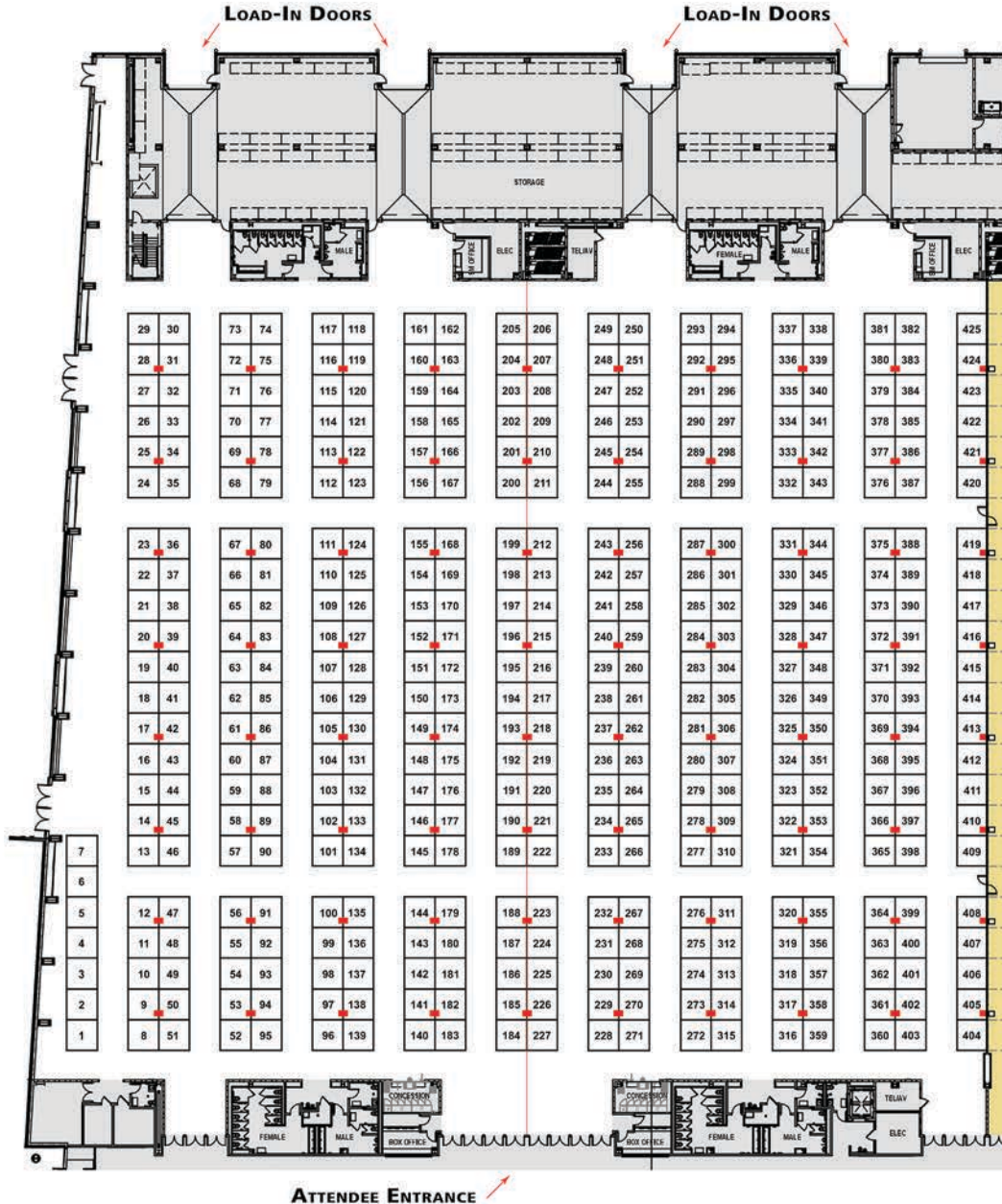

**EVENT COORDINATOR:
WALT JANKE
920-470-6444**

**LOAD-IN TIMES:
THURSDAY 8AM - 8PM
FRIDAY 7AM - 2PM**

**LOAD-OUT TIME:
SUNDAY 4PM**

**SHOW TIMES:
FRIDAY 3PM - 9PM
SATURDAY 9AM - 7PM
SUNDAY 10AM - 4PM**

**RESCH EXPO CENTER
840 ARMED FORCES DR
ASHWAUBENON, WI**

EXPO HALL A AND B

ARMED FORCES DRIVE